

STATEMENT OF SIGNIFICANCE

7 Fischer Court

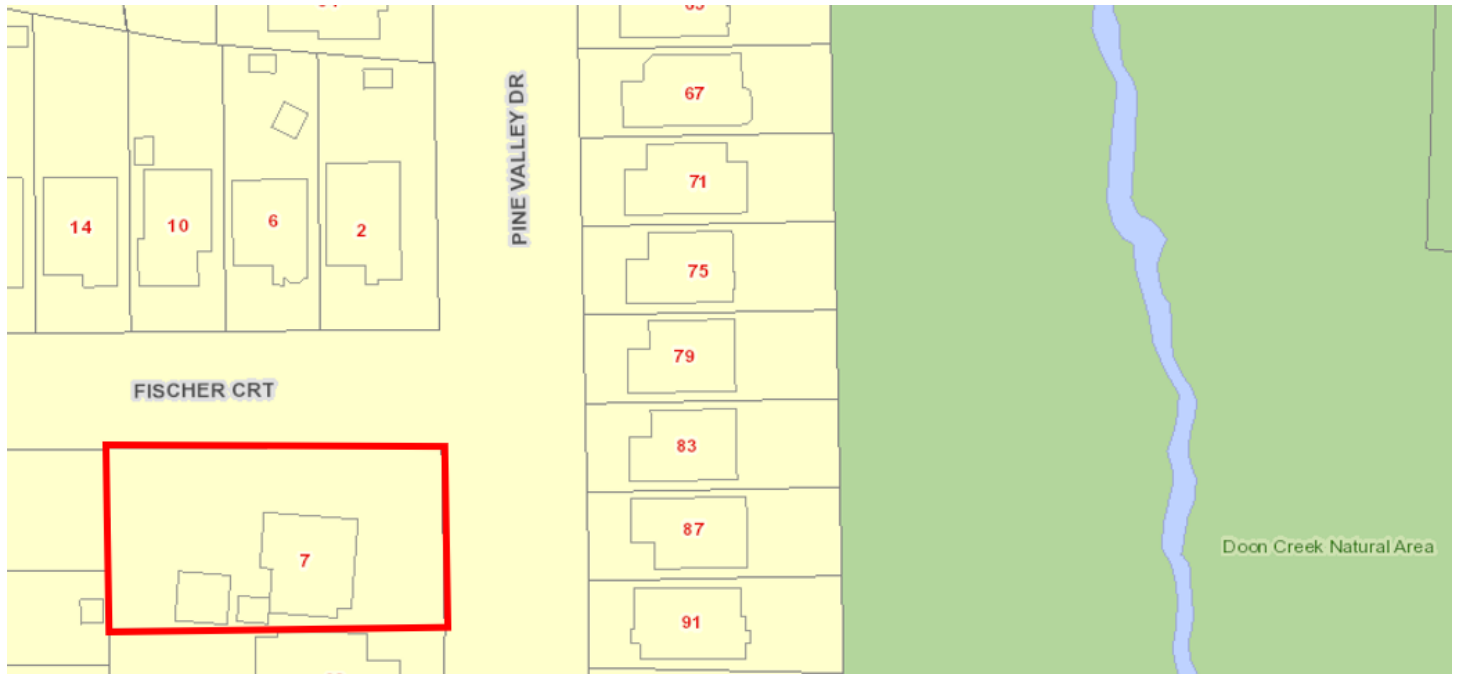

Summary of Significance

Design/Physical Value

Associative/Historical Value

Contextual Value

Social Value

Economic Value

Environmental Value

Municipal Address: 7 Fischer Court

Legal Description: Reg Plan 58M-316 Lot 148

Year Built: c. 1860

Architectural Style: Log

Original Owner: William Fischer

Original Use: Residential

Condition: Good

Description of Cultural Heritage Resource

7 Fischer Court (previously 1 Oregon Drive) is a three-storey mid-19th century log house. The house is situated on a 0.29-acre parcel of land located on the south side of Fischer Court at the intersection of Fischer Court and Pine Valley Drive in the Doon South Neighbourhood of the City of Kitchener within the Region of Waterloo. The house is the principal resource that contributes to the heritage value.

Heritage Value

7 Fischer Court is recognized for its design/physical, and associative/historic values.

Design/Physical Value

The property municipally addressed as 7 Fischer Court demonstrates design/physical value as a rare, unique and unexpected example of a late 19th-century 'wedding cake' design log house in a rural setting. According to the late Nicholas Hill, Architect Planner, "*The style smacks of high architectural vogue, commissioned by a client with adventurous taste.*" The building significantly altered over the years; however, it was rehabilitated in the late 1990s/early 2000s. The building has both original and rehabilitated heritage attributes in good condition including: 2.5 storey square plan; log construction with a 'wedding cake' design; cedar shingles; pyramidal roof with glass roof lantern; pine fascia and frieze; prefinished metal covered wood windows with muntins; wraparound verandah; and, a stone foundation under a portion of the house. The original smokehouse was relocated and reconstructed on this lot in the new subdivision.

Front (East) Façade

The front of the building faces Pine Valley Drive and is comprised of three somewhat irregular bays. The most prominent feature of the building is its "wedding cake" design with the use of log construction. The centre bay features the front door and a prefinished metal covered wood window on the first floor while the two end bays on this floor feature matching prefinished metal covered wood windows with muntins. The first floor also features a reconstructed wraparound verandah, which is slightly off centre (closer to the east façade). The verandah displays a hip roof with cedar shingles, six pine posts and pine railings. The second storey features three prefinished metal covered wood windows with muntins while the two end windows align with the windows on the first floor. The third floor features the pyramidal cedar shingle roof, pine fascia and frieze and glass roof lantern with prefinished metal covered wood windows with muntins.

Side (North) Façade

The north side façade faces Fischer Court and features two bays. The first floor contains two doors and one prefinished metal covered wood window with muntins near the north-west corner of the house. This floor also features a reconstructed wraparound verandah, which unlike the front façade is symmetrical. The verandah displays a hip roof with cedar shingles, six pine posts and pine railings. The second floor features two prefinished metal covered wood windows with muntins along with one window aligning with a door on the first floor while the other window aligns with the window on the first floor. The third storey features the pyramidal cedar shingle roof, pine fascia and frieze and glass roof lantern with prefinished metal wood windows with muntins.

Side (South) Façade

The south side façade faces the surrounding subdivision and features two bays. The first and second floor both display two matching prefinished metal covered wood windows with muntins that are aligned above/below one another. The third storey features the pyramidal cedar shingle roof, pine fascia and frieze and glass roof lantern with prefinished metal covered wood windows with muntins.

Rear (West) Façade

The rear façade faces the surrounding subdivision and features two bays. The first floor displays one door and one prefinished metal covered wood window with muntins. This floor also features a wraparound verandah that extends across approximately half of the rear façade. The verandah displays a hip roof with cedar shingles, four pine posts and pine railings. The second floor features two prefinished metal covered wood windows with muntins that are aligned with the door and window on

the first floor. The third storey features the pyramidal cedar shingle roof, pine fascia and frieze and glass roof lantern with prefinished metal covered wood windows with muntins.

Interior

The interior features a central circular staircase from the basement leading up to the glass roof lantern on the third floor. In 1997, this staircase was nearly original including treads, risers, side panels, handrail and spindles (Hill, 1997).

Historical/Associative Value

The property municipally addressed as 7 Fischer Court has historical/associative value due to history and association with early settlement, Richard Beasley, John Biehn, the Stauffer family, and the Fisher/Fischer family.

Ownership through the 1800s is difficult to confirm. However, the lands are associated with early settlement, Richard Beasley, John Biehn, and the Fisher/Fischer family.

Richard Beasley sold land in the Lower Block between 1800 and 1803 (Bloomfield et al., 1994). Research completed in 1996-97 by Nicholas Hill, Architect Planner, suggested that the house was built on Lot 3 of Biehn's Tract. Contrary to Nicholas Hill's research, assessment roll evidence from 1881 suggests that William Fischer owned Lot 5 of Biehn's Tract (Bloomfield et al, 1994).

). The assessment roll also indicated that William Fischer was 46 years old and a farmer with 148 acres of land, of which 110 were cultivated, and he had four horses, eight cattle, 18 sheep, and five hogs. The value of the land in 1881 was \$3,300.

Members of the Fischer family also owned land in Bechtel's Tract including George Fischer, George W. Fischer, John Fischer, Nelson Fischer, Philip Fischer, and William Fischer.

Research also suggests that Cecil Fischer lived on the farm from 1925 to 1970 (Hill, 1997). Cecil's parents were Father John Burnham Fischer and Ida May Wismer.

Contextual Value (Historic)

Historically, the house was located on an active farm. The glass roof lantern on the third floor was used to check on the ploughing of the fields (Hill, 1997). It was also a great place for artists to set up their canvases (Hill, 1997).

Heritage Attributes

The heritage value of 7 Fischer Court resides in the following heritage attributes:

- late 19th-century 'wedding cake' design;
- 2.5 storey square plan;
- log construction;
- cedar shingles;
- pyramidal roof with glass roof lantern;
- pine fascia and frieze;
- prefinished metal covered wood windows with muntins;
- wraparound verandah; and,
- a stone foundation under a portion of the house;
- the relocated and reconstructed original smokehouse;

- the front façade with three somewhat irregular bays:
 - the centre bay front door and prefinished metal covered wood window on the first floor;
 - the two end bays with matching prefinished metal covered wood windows with muntins;
 - the reconstructed wraparound verandah with hip roof covered by cedar shingles, six pine posts and pine railings;
 - the three prefinished metal covered wood windows with muntins on the second floor;
 - the third floor pyramidal cedar shingle roof, pine fascia and frieze and glass roof lantern with prefinished metal covered wood windows with muntins.
- The north side façade with two bays:
 - the two doors and prefinished metal covered wood window with muntins near the north-west corner of the house on the first floor;
 - the reconstructed wraparound verandah with hip roof covered by cedar shingles, six pine posts and pine railings;
 - the two prefinished metal covered wood windows with muntins;
 - the third floor pyramidal cedar shingle roof, pine fascia and frieze and glass roof lantern with prefinished metal covered wood windows with muntins.
- The south side façade with two bays:
 - the two matching prefinished metal covered wood windows with muntins that are aligned above/below one another;
 - the third storey pyramidal cedar shingle roof, pine fascia and frieze and glass roof lantern with prefinished metal covered wood windows with muntins.
- The rear façade with two bays:
 - the door and prefinished metal covered wood window with muntins on the first floor;
 - the wraparound verandah with hip roof covered by cedar shingles, four pine posts and pine railings;
 - the prefinished metal covered wood windows with muntins;
 - the third storey pyramidal cedar shingle roof, pine fascia and frieze and glass roof lantern with prefinished metal covered wood windows with muntins.

References

Bergey, L., (1977). *A history of the Stauffers Families Who Came to Ontario*. Stauffer Family Historical Committee: Kitchener-Waterloo, ON.

Bloomfield, E., L. Foster & L.W. Laliberte. (1994). *The Waterloo Township Cadastre in 1861*. Guelph: Department of Geography, University of Guelph.

Hill, N. (1997). *Wyldwoods Neighbourhood Doon South Community City of Kitchener Heritage Impact Assessment*. Kitchener ON: Nicolas Hill & Green Scheels and Pidgeon.

Photographs



Context: Front Elevation (East Façade) of 7 Fischer Court located on a corner lot within a suburban subdivision



Front Elevation (East Façade)



Side Elevation (North Façade) & Rear Elevation (West Façade)



Side Elevation (South Façade)



Detail of the pyramidal cedar shingle roof, pine fascia and frieze and glass roof lantern with prefinished metal covered wood windows with muntins



Detail of first storey covered verandah with cedar shingle roof, pine posts and pine railings