



# Albert McCormick Community Centre (AMCC) Renovation

## Introduction to Team:

- Project Manager, Heather Liddycoat
- Project Coordinator, Mary Cathryn Lorentz
- Consultant, Ward 99 (*ESBL Consultant*)
- Contractor, to be determined



## Projects for Discussion:

- **AMCC Renovation, Phase A - Energy and Accessibility Retrofit**
  - Construction Start May 2025
  - Construction Completion March 2026
- **AMCC Renovation, Phase B - McCormick Branch Library and AMCC Renovation and Expansion Project**
  - Construction Start, April 2026
  - Construction Completion, Summer 2027



# Phase A - Energy and Accessibility Retrofit

## Project Focus:

Improve energy efficiency & reduce greenhouse gas emissions:

- **Key upgrades:**
    - Building enclosure improvements
    - Enhanced controls
    - Dehumidification systems
    - LED lighting installation
    - Refrigeration upgrades
    - Electrification of heating systems
    - New washroom corridor
  - **Accessibility Enhancements:**
    - Addition of a universal washroom
    - Updates to existing changerooms
-



# Phase A - Energy and Accessibility Retrofit Location

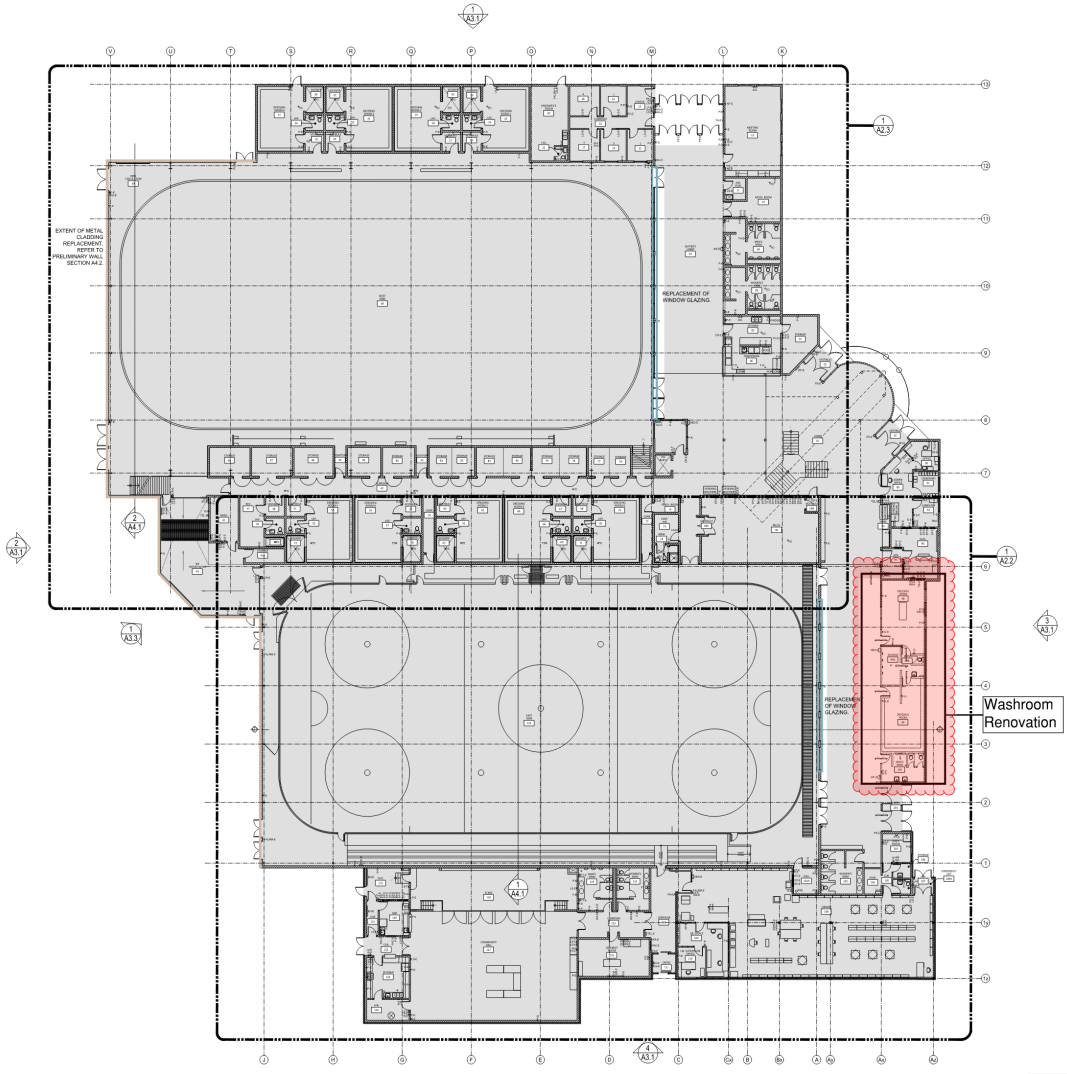



## Phase A - Accessibility Retrofit Overview

- Renovation of the East corridor, including the washroom, changeroom, office, and entrance.
- Upgrading interior doors and windows between the ice rinks and community areas to improve thermal performance and accessibility.
- Construction of 12 new single-occupant washrooms, including 2 barrier-free washrooms.
- Addition of 1 new universal washroom/changeroom, featuring:
  - Ceiling lift
  - Adult change table
  - Accessible shower
- Modifying changerooms to create 2 new gender-neutral changerooms with showers.
- Installing new tactile to enhance accessibility.





## Phase A - Accessibility Retrofit (Tactile)

### Installing New Tactile to Enhance Accessibility:

- New tactile pathway from East vestibule to Universal Washroom/Changeroom.

### Questions for GRAAC:

- Should tactile included to shower area?
- Should tactile be added to water fountains?
- Review tactile layout within washroom space to avoid cramping of decision trees.

# Phase A - Accessibility Retrofit (Tactile Wayfinding)







# Tactile in Universal Washroom

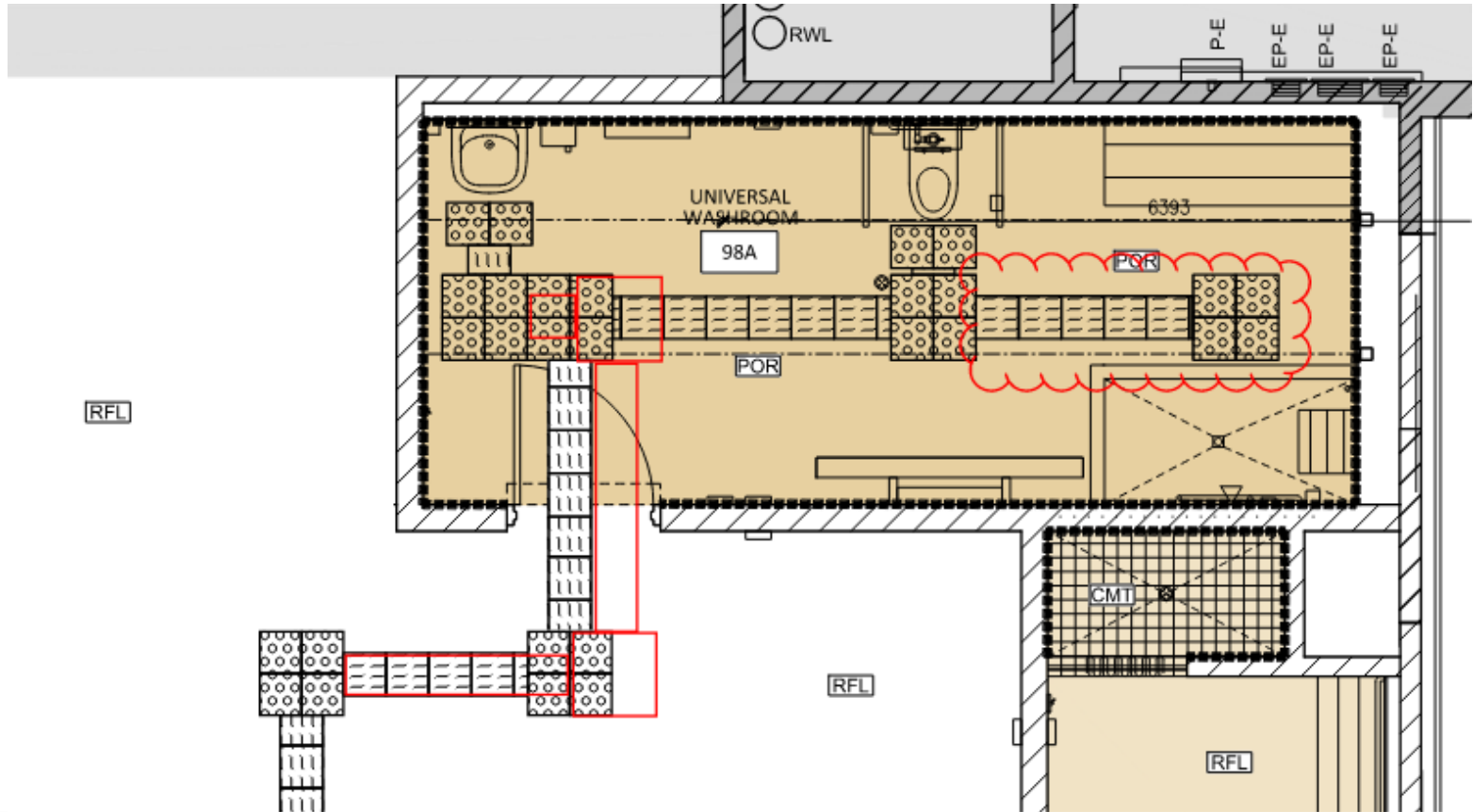



## **Phase B - McCormick Branch Library and AMCC Renovation and Expansion Project**

### **New City Community Room:**

- Expanded and modernized double-height space for recreational activities, camps, sports, and large gatherings.
- Community room will include hearing loops.
- Barrier free washroom centrally located between community room and Library.

### **New City Barrier Free Commercial Kitchen & Servery:**

- Fully-equipped commercial kitchen with direct access to the community room
- Features: barrier free design, refrigerators, freezer, induction ranges, triple sink, dishwasher, and ample counter space.



## **Phase B - McCormick Branch Library and AMCC Renovation and Expansion Project continued**

### **WPL Library Addition & Renovation:**

- Welcoming entrance with a foyer connecting the library to the Community Centre.
- Double-height open library entry with lounge, mobile displays, and self-checkout stations.
- Spacious layout for library collection, children's area, computers, and business centre.
- New glass-enclosed library program room.



**Questions?**

**Thank you!**