

SITE AREA:	2,288m ²	PARKING:	218 spaces
UNITS:	332 units	RESIDENTIAL:	129 spaces (0.58 space/unit)
DENSITY:	1,451 upha	COMMERCIAL:	25 spaces (1 space/22.5m ²)
COMMERCIAL AREA:	560m ²		
GFA:	40,407m ²		
FSR:	17.66		
HEIGHT:	30 storeys		
MIN. TOWER SEPARATION:	12.0 m*		
*based on draft SGA-4 zoning regulations			

UNDERGROUND PARKING:
48 spaces

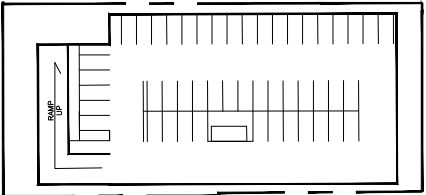

L1 PODIUM:
34 spaces

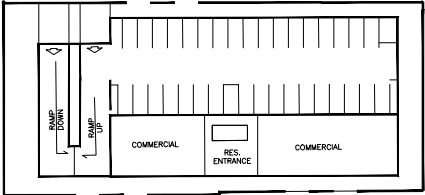

L2 - L4 PODIUM:
102 spaces

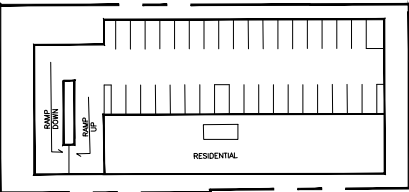

L5 PODIUM:
34 spaces

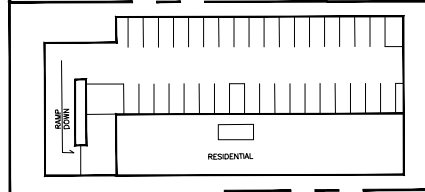

DEVELOPMENT CONCEPT 1
924-938, 940, & 944 King Street West, Kitchener

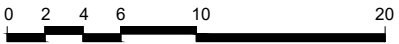

NOTE: This concept should be considered as a preliminary demonstration model that illustrates an 'order of magnitude' development scenario for the site. The number of units, floor area and parking supply are approximate and subject to more detailed design as well as municipal planning approvals.

Scale 1:400 | December 18, 2023 | Project No.: 22263 | Drawn By: MN



GSP
group