

**CITY OF KITCHENER
OFFICIAL PLAN
AMENDMENT TO MAP 4
URBAN GROWTH CENTRE (DOWNTOWN)**

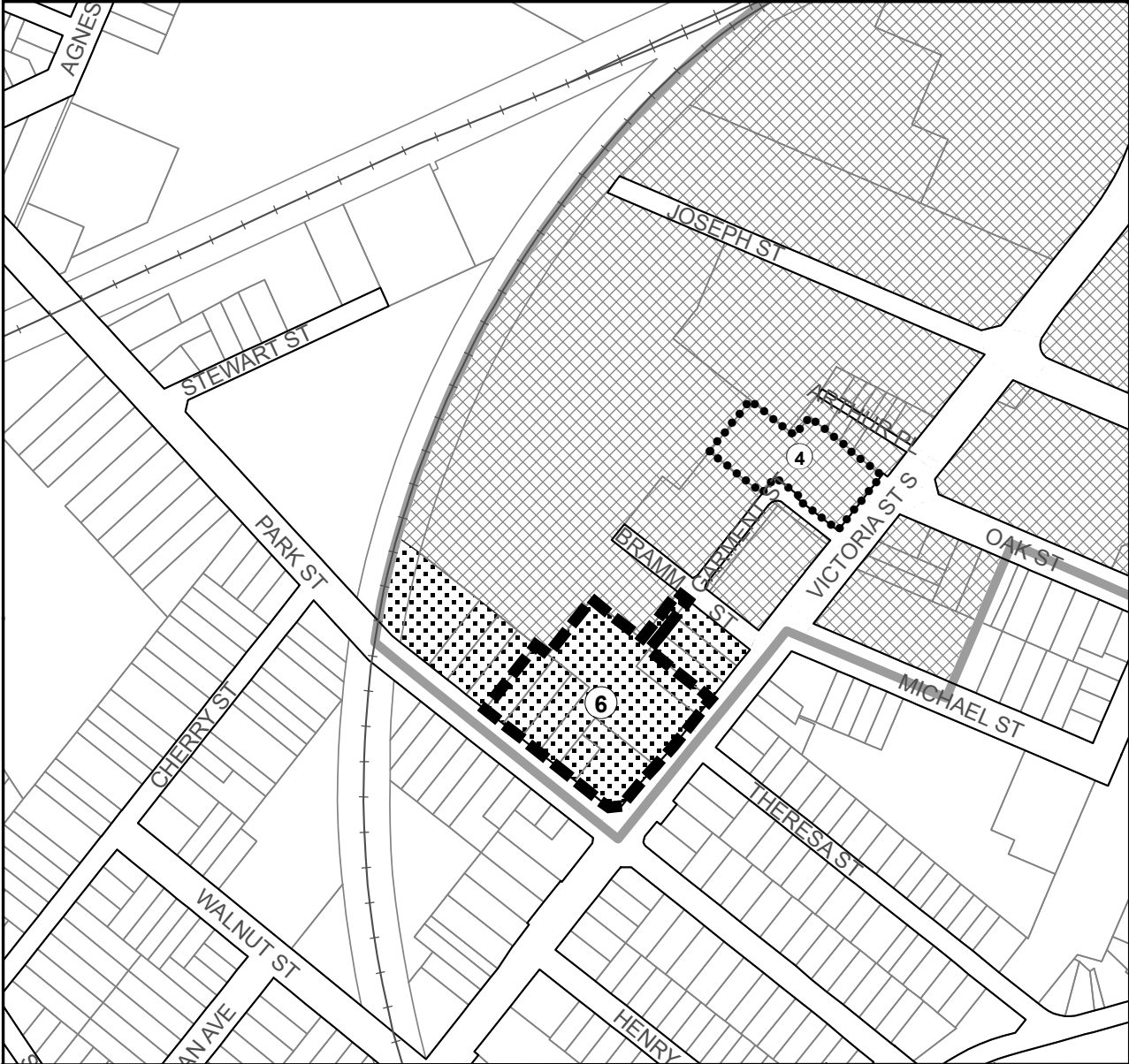

Urban Growth Centre (Downtown)

 Boundary

Land Use Designation

 Innovation District

 Mixed Use

Specific Policy Area

 Boundary

Area of Amendment

To Add Specific Policy Area
6. 146-162 Victoria St S &
92-110 Park St
(Policy 15.D.2.69)



SCHEDULE 'A'

INNOVATION PARK KITCHENER LIMITED;
INNOVATION DEVELOPMENTS KITCHENER LIMITED;
162 VICTORIA LIMITED; 1936026 ONTARIO INC.

146-162 VICTORIA ST S & 92-110 PARK ST



SCALE 1:4,000

DATE: MAY 12, 2022

REVISED:

OFFICIAL PLAN AMENDMENT OPA21/011/V/ES

ZONING BY-LAW AMENDMENT ZBA21/017/V/ES

City of Kitchener

DEVELOPMENT SERVICES DEPARTMENT, PLANNING

FILE:
OPA21011VES_MAP4
.mxd